

PRODUCT-DETAILS

AP235 SQ SS

SQ POST BASE CONN HT3.5IN SS

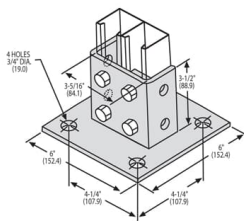

General Information

| | |
|-----------------------|--|
| Extended Product Type | AP235 SQ SS |
| Product ID | 7TAA005680R0005 |
| EAN | 0616013015001 |
| Catalog Description | SQ POST BASE CONN HT3.5IN SS |
| Long Description | Connector, Square Post Base, Post Height 3-1/2 Inch, Post Width 3-3/4 Inch, Post Length 1-5/8 Inch, Base Length 6 Inches, Base Width 6 Inches, Hole Diameter 3/4 Inch, Stainless Steel |

Ordering

| | |
|-------------------------|--------------------|
| EAN | 0616013015001 |
| UPC | 616013015001 |
| Country of Origin | United States (US) |
| Customs Tariff Number | 7326908695 |
| Selling Unit of Measure | each |

Dimensions

| | |
|----------------------------|----------|
| Product Net Width | 6 in |
| Product Net Height | 3-1/2 in |
| Product Net Depth / Length | 6 in |

Container Information

| | |
|--------------------------------|--------------------|
| Package Level 1 Units | 10 piece |
| Package Level 1 Width | 10.6 in 269 mm |
| Package Level 1 Height | 5.3 in 135 mm |
| Package Level 1 Depth / Length | 17.79 in 452 mm |

Additional Information

| | |
|---------------------|---------------------------------------|
| Application | For use in metal framing applications |
| Brand / Label | Superstrut |
| Effective Date | 19940629 |
| Material | Stainless Steel |
| Number of Batteries | 0 |
| Product Name | SUPERSTRUT CHANNEL & ACCES |
| Product Type | Fittings, Brackets & Hardware |
| Special Functions | Excellent corrosion resistance |

Certificates and Declarations (Document Number)

| | |
|-----------------------------------|-------------|
| Data Sheet, Technical Information | AP235 SQ SS |
| Instructions and Manuals | AP235 SQ SS |

Classifications

| | |
|------------------------------------|---|
| ETIM 6 | EC000482 - Mounting element for support/profile rail |
| ETIM 7 | EC000482 - Mounting element for support/profile rail |
| ETIM 8 | EC000482 - Fastening element for mounting rail/-profile |
| UNSPSC | 31162502 |
| WEEE Category | Product Not in WEEE Scope |
| IDEA Granular Category Code (IGCC) | 3010 >> Angle brackets |

Categories

Low Voltage Products and Systems → Installation Products → Wire Management and Connectivity → Metal Framing & Accessories

